

■ SMD Wire Wound Chip Inductor

结构及外形尺寸 Dimensions of structure and shape

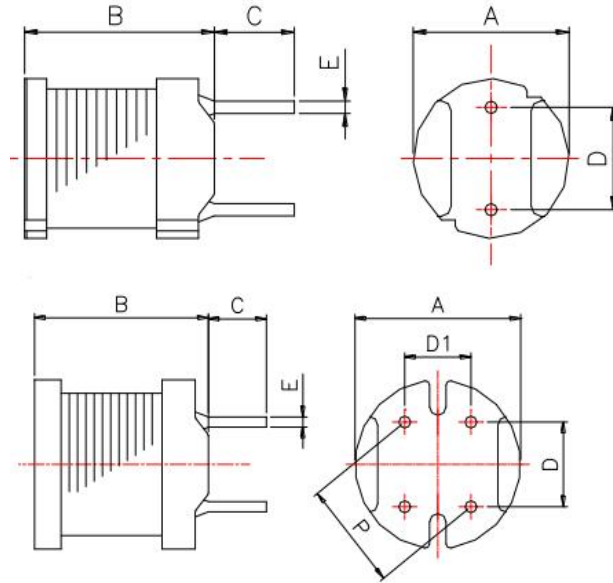

Part Number	Dimensions	Dimensions	Dimensions	Dimensions	Dimensions	Dimensions	Dimensions
	A (mm)	B(mm)	C(mm)	D(mm)	D1(mm)	E(mm)	P(mm)
GCPK0664N	6.0±0.5	6.50 max	4.0±1.0	4.0±0.3	-	0.50±0.1	-
GCPK0855N	7.8±0.5	5.50 max	5.0±1.0	5.0±0.3	-	0.65±0.1	-
GCPK0875N	7.8±0.5	7.50 max	5.0±1.0	5.0±0.3	-	0.65±0.1	-
GCPK0895N	7.8±0.5	9.50 max	5.0±1.0	5.0±0.3	-	0.65±0.1	-
GCPK1010N	10.0±0.5	10.50 max	3.5±1.0	5.0±0.3	4.0±0.3	0.70±0.1	6.40±0.5

特点 Features

- 高密度设计, 体积小, 成本低
- Density design, small size, and low cost
- 相对较大的额定电流和高电感
- Comparatively range rated current and high inductance
- 低DCR和高稳定性的插件结构
- Low DCR and high dip stability

应用 Applications

- 个人电脑
- Personal Computers
- 电池动力设备
- Variety of Battery Power Equipment
- 直流电源电路
- DC Power Supply Circuits

电感特性范围 Inductance and rated current ranges

GCPK0664N	22~1000uH	110~4450mΩ	1.27~0.19A
GCPK0855N	10~10000uH	70~55700mΩ	2.50~0.081A
GCPK0875N	10~10000uH	50~33000mΩ	2.90~0.084A
GCPK0895N	10~47000uH	40~96400mΩ	2.60~0.038A
GCPK1010N	10~1000uH	22~1800mΩ	5.30~0.53A

包装数量 Packaging Quantity

GCPK0664N	200PCS/BOX
GCPK0855N	200PCS/BOX
GCPK0875N	200PCS/BOX
GCPK0895N	200PCS/BOX
GCPK1010N	144PCS/BOX

★ 产品可以按客户要求定制

Products can be customized according to customer requirements

本产品符合车载信赖性标准AEC-Q200

This product Complied with automotive reliability test standard AEC-Q200



GCPK Series (UNSHIELDED)

ELECTRICAL SPECIFICATION

GCPK0664N Series (Quantity: 200PCS)/GCPK0664N 系列 (数量: 200PCS)

Part Number	Marking	Inductance (μ H)	DCR (Ω) max.	Test Freq. (Hz)	Saturation Current(A)
GCPK0664N-220M01	-	22	0.11	100KHz/0.1v	1.27
GCPK0664N-270M01	-	27	0.14	100KHz/0.1v	1.14
GCPK0664N-330M01	-	33	0.17	100KHz/0.1v	1.03
GCPK0664N-390M01	-	39	0.19	100KHz/0.1v	0.95
GCPK0664N-470M01	-	47	0.23	100KHz/0.1v	0.87
GCPK0664N-560M01	-	56	0.26	100KHz/0.1v	0.80
GCPK0664N-680M01	-	68	0.28	100KHz/0.1v	0.72
GCPK0664N-820M01	-	82	0.39	100KHz/0.1v	0.66
GCPK0664N-101K01	-	100	0.43	1KHz/0.1v	0.59
GCPK0664N-121K01	-	120	0.54	1KHz/0.1v	0.54
GCPK0664N-151K01	-	150	0.64	1KHz/0.1v	0.48
GCPK0664N-181K01	-	180	0.74	1KHz/0.1v	0.44
GCPK0664N-221K01	-	220	0.96	1KHz/0.1v	0.40
GCPK0664N-271K01	-	270	1.12	1KHz/0.1v	0.36
GCPK0664N-331K01	-	330	1.48	1KHz/0.1v	0.33
GCPK0664N-391K01	-	390	1.66	1KHz/0.1v	0.30
GCPK0664N-471K01	-	470	1.91	1KHz/0.1v	0.27
GCPK0664N-561K01	-	560	2.31	1KHz/0.1v	0.25
GCPK0664N-681K01	-	680	2.67	1KHz/0.1v	0.23
GCPK0664N-821K01	-	820	3.10	1KHz/0.1v	0.21
GCPK0664N-102K01	-	1000	4.45	1KHz/0.1v	0.19



GCPK Series (UNSHIELDED)

ELECTRICAL SPECIFICATION

GCPK0855N Series (Quantity: 200PCS)/GCPK0855N 系列 (数量: 200PCS)					
Part Number	Marking	Inductance (μ H)	DCR (Ω) max.	Test Freq. (Hz)	Saturation Current(A)
GCPK0855N-100M01	-	10	0.07	100KHz/0.1v	2.500
GCPK0855N-120M01	-	12	0.08	100KHz/0.1v	2.400
GCPK0855N-150M01	-	15	0.09	100KHz/0.1v	2.100
GCPK0855N-180M01	-	18	0.10	100KHz/0.1v	2.000
GCPK0855N-220M01	-	22	0.12	100KHz/0.1v	1.700
GCPK0855N-270M01	-	27	0.14	100KHz/0.1v	1.600
GCPK0855N-330M01	-	33	0.17	100KHz/0.1v	1.400
GCPK0855N-390M01	-	39	0.21	100KHz/0.1v	1.300
GCPK0855N-470M01	-	47	0.24	100KHz/0.1v	1.200
GCPK0855N-560M01	-	56	0.31	100KHz/0.1v	1.100
GCPK0855N-680M01	-	68	0.34	100KHz/0.1v	1.000
GCPK0855N-820M01	-	82	0.40	100KHz/0.1v	0.930
GCPK0855N-101K01	-	100	0.52	1KHz/0.1v	0.810
GCPK0855N-121K01	-	120	0.59	1KHz/0.1v	0.760
GCPK0855N-151K01	-	150	0.71	1KHz/0.1v	0.670
GCPK0855N-181K01	-	180	0.89	1KHz/0.1v	0.620
GCPK0855N-221K01	-	220	1.04	1KHz/0.1v	0.540
GCPK0855N-271K01	-	270	1.28	1KHz/0.1v	0.490
GCPK0855N-331K01	-	330	1.47	1KHz/0.1v	0.440
GCPK0855N-391K01	-	390	1.67	1KHz/0.1v	0.410
GCPK0855N-471K01	-	470	1.95	1KHz/0.1v	0.380
GCPK0855N-561K01	-	560	2.83	1KHz/0.1v	0.350
GCPK0855N-681K01	-	680	3.25	1KHz/0.1v	0.320
GCPK0855N-821K01	-	820	3.82	1KHz/0.1v	0.310
GCPK0855N-102K01	-	1000	5.28	1KHz/0.1v	0.250
GCPK0855N-122K01	-	1200	6.03	1KHz/0.1v	0.230
GCPK0855N-152K01	-	1500	7.15	1KHz/0.1v	0.210
GCPK0855N-182K01	-	1800	8.26	1KHz/0.1v	0.200
GCPK0855N-222K01	-	2200	11.10	1KHz/0.1v	0.180
GCPK0855N-272K01	-	2700	13.10	1KHz/0.1v	0.160
GCPK0855N-332K01	-	3300	15.90	1KHz/0.1v	0.140
GCPK0855N-392K01	-	3900	18.00	1KHz/0.1v	0.130
GCPK0855N-472K01	-	4700	23.90	1KHz/0.1v	0.120
GCPK0855N-562K01	-	5600	26.80	1KHz/0.1v	0.110
GCPK0855N-682K01	-	6800	31.70	1KHz/0.1v	0.098
GCPK0855N-822K01	-	8200	46.50	1KHz/0.1v	0.088
GCPK0855N-103K01	-	10000	55.70	1KHz/0.1v	0.081



GCPK Series (UNSHIELDED)

ELECTRICAL SPECIFICATION

GCPK0875N Series (Quantity: 200PCS)/GCPK0875N 系列 (数量: 200PCS)					
Part Number	Marking	Inductance (μ H)	DCR (Ω) max.	Test Freq. (Hz)	Saturation Current(A)
GCPK0875N-100M01	-	10	0.05	100KHz/0.1v	2.900
GCPK0875N-120M01	-	12	0.06	100KHz/0.1v	2.500
GCPK0875N-150M01	-	15	0.07	100KHz/0.1v	2.200
GCPK0875N-180M01	-	18	0.08	100KHz/0.1v	1.900
GCPK0875N-220M01	-	22	0.09	100KHz/0.1v	1.800
GCPK0875N-270M01	-	27	0.11	100KHz/0.1v	1.700
GCPK0875N-330M01	-	33	0.13	100KHz/0.1v	1.500
GCPK0875N-390M01	-	39	0.14	100KHz/0.1v	1.300
GCPK0875N-470M01	-	47	0.15	100KHz/0.1v	1.300
GCPK0875N-560M01	-	56	0.18	100KHz/0.1v	1.200
GCPK0875N-680M01	-	68	0.20	100KHz/0.1v	1.100
GCPK0875N-820M01	-	82	0.24	100KHz/0.1v	1.000
GCPK0875N-101K01	-	100	0.28	1KHz/0.1v	0.890
GCPK0875N-121K01	-	120	0.36	1KHz/0.1v	0.810
GCPK0875N-151K01	-	150	0.42	1KHz/0.1v	0.720
GCPK0875N-181K01	-	180	0.57	1KHz/0.1v	0.660
GCPK0875N-221K01	-	220	0.63	1KHz/0.1v	0.570
GCPK0875N-271K01	-	270	0.88	1KHz/0.1v	0.510
GCPK0875N-331K01	-	330	1.05	1KHz/0.1v	0.460
GCPK0875N-391K01	-	390	1.17	1KHz/0.1v	0.440
GCPK0875N-471K01	-	470	1.34	1KHz/0.1v	0.410
GCPK0875N-561K01	-	560	1.72	1KHz/0.1v	0.360
GCPK0875N-681K01	-	680	1.96	1KHz/0.1v	0.330
GCPK0875N-821K01	-	820	2.56	1KHz/0.1v	0.300
GCPK0875N-102K01	-	1000	2.94	1KHz/0.1v	0.270
GCPK0875N-122K01	-	1200	4.04	1KHz/0.1v	0.240
GCPK0875N-152K01	-	1500	4.70	1KHz/0.1v	0.220
GCPK0875N-182K01	-	1800	5.05	1KHz/0.1v	0.200
GCPK0875N-222K01	-	2200	6.25	1KHz/0.1v	0.180
GCPK0875N-272K01	-	2700	8.72	1KHz/0.1v	0.160
GCPK0875N-332K01	-	3300	10.60	1KHz/0.1v	0.150
GCPK0875N-392K01	-	3900	14.20	1KHz/0.1v	0.140
GCPK0875N-472K01	-	4700	16.70	1KHz/0.1v	0.120
GCPK0875N-562K01	-	5600	18.70	1KHz/0.1v	0.110
GCPK0875N-682K01	-	6800	21.80	1KHz/0.1v	0.100
GCPK0875N-822K01	-	8200	28.70	1KHz/0.1v	0.093
GCPK0875N-103K01	-	10000	33.00	1KHz/0.1v	0.084



GCPK Series (UNSHIELDED)

ELECTRICAL SPECIFICATION

GCPK0895N Series (Quantity: 200PCS)/GCPK0895N 系列 (数量: 200PCS)					
Part Number	Marking	Inductance (μ H)	DCR (Ω) max.	Test Freq. (Hz)	Saturation Current(A)
GCPK0895N-100M01	-	10	0.04	100KHz/0.1v	2.600
GCPK0895N-120M01	-	12	0.04	100KHz/0.1v	2.600
GCPK0895N-150M01	-	15	0.05	100KHz/0.1v	2.100
GCPK0895N-180M01	-	18	0.05	100KHz/0.1v	2.000
GCPK0895N-220M01	-	22	0.06	100KHz/0.1v	1.700
GCPK0895N-270M01	-	27	0.06	100KHz/0.1v	1.600
GCPK0895N-330M01	-	33	0.07	100KHz/0.1v	1.400
GCPK0895N-390M01	-	39	0.08	100KHz/0.1v	1.400
GCPK0895N-470M01	-	47	0.10	100KHz/0.1v	1.300
GCPK0895N-560M01	-	56	0.11	100KHz/0.1v	1.200
GCPK0895N-680M01	-	68	0.14	100KHz/0.1v	1.100
GCPK0895N-820M01	-	82	0.16	100KHz/0.1v	1.000
GCPK0895N-101K01	-	100	0.19	1KHz/0.1v	0.900
GCPK0895N-121K01	-	120	0.22	1KHz/0.1v	0.820
GCPK0895N-151K01	-	150	0.27	1KHz/0.1v	0.740
GCPK0895N-181K01	-	180	0.31	1KHz/0.1v	0.710
GCPK0895N-221K01	-	220	0.38	1KHz/0.1v	0.640
GCPK0895N-271K01	-	270	0.53	1KHz/0.1v	0.570
GCPK0895N-331K01	-	330	0.61	1KHz/0.1v	0.510
GCPK0895N-391K01	-	390	0.69	1KHz/0.1v	0.480
GCPK0895N-471K01	-	470	0.89	1KHz/0.1v	0.430
GCPK0895N-561K01	-	560	1.01	1KHz/0.1v	0.400
GCPK0895N-681K01	-	680	1.18	1KHz/0.1v	0.350
GCPK0895N-821K01	-	820	1.57	1KHz/0.1v	0.320
GCPK0895N-102K01	-	1000	1.84	1KHz/0.1v	0.300
GCPK0895N-122K01	-	1200	2.10	1KHz/0.1v	0.270
GCPK0895N-152K01	-	1500	2.80	1KHz/0.1v	0.230
GCPK0895N-182K01	-	1800	3.21	1KHz/0.1v	0.210
GCPK0895N-222K01	-	2200	4.21	1KHz/0.1v	0.190
GCPK0895N-272K01	-	2700	4.94	1KHz/0.1v	0.170
GCPK0895N-332K01	-	3300	6.16	1KHz/0.1v	0.150
GCPK0895N-392K01	-	3900	6.84	1KHz/0.1v	0.140
GCPK0895N-472K01	-	4700	7.89	1KHz/0.1v	0.130
GCPK0895N-562K01	-	5600	11.50	1KHz/0.1v	0.120
GCPK0895N-682K01	-	6800	13.20	1KHz/0.1v	0.110
GCPK0895N-822K01	-	8200	15.20	1KHz/0.1v	0.100
GCPK0895N-103K01	-	10000	22.00	1KHz/0.1v	0.089
GCPK0895N-123K01	-	12000	25.00	1KHz/0.1v	0.073
GCPK0895N-153K01	-	15000	29.10	1KHz/0.1v	0.068
GCPK0895N-183K01	-	18000	38.90	1KHz/0.1v	0.066
GCPK0895N-223K01	-	22000	44.90	1KHz/0.1v	0.059
GCPK0895N-273K01	-	27000	55.70	1KHz/0.1v	0.052
GCPK0895N-333K01	-	33000	64.20	1KHz/0.1v	0.048
GCPK0895N-393K01	-	39000	74.20	1KHz/0.1v	0.042
GCPK0895N-473K01	-	47000	96.40	1KHz/0.1v	0.038



GCPK Series (UNSHIELDED)

ELECTRICAL SPECIFICATION

GCPK1010N Series (Quantity: 144PCS)/GCPK1010N 系列 (数量: 144PCS)					
Part Number	Marking	Inductance (μ H)	DCR (Ω) max.	Test Freq. (Hz)	Saturation Current(A)
GCPK1010N-100M01	-	10	0.022	100KHz/0.1v	5.300
GCPK1010N-120M01	-	12	0.023	100KHz/0.1v	4.900
GCPK1010N-150M01	-	15	0.026	100KHz/0.1v	4.400
GCPK1010N-180M01	-	18	0.033	100KHz/0.1v	4.000
GCPK1010N-220M01	-	22	0.037	100KHz/0.1v	3.600
GCPK1010N-270M01	-	27	0.048	100KHz/0.1v	3.300
GCPK1010N-330M01	-	33	0.055	100KHz/0.1v	2.900
GCPK1010N-390M01	-	39	0.073	100KHz/0.1v	2.700
GCPK1010N-470M01	-	47	0.083	100KHz/0.1v	2.500
GCPK1010N-560M01	-	56	0.092	100KHz/0.1v	2.300
GCPK1010N-680M01	-	68	0.120	100KHz/0.1v	2.100
GCPK1010N-820M01	-	82	0.140	100KHz/0.1v	1.900
GCPK1010N-101K01	-	100	0.160	1KHz/0.1v	1.700
GCPK1010N-121K01	-	120	0.200	1KHz/0.1v	1.500
GCPK1010N-151K01	-	150	0.230	1KHz/0.1v	1.400
GCPK1010N-181K01	-	180	0.310	1KHz/0.1v	1.300
GCPK1010N-221K01	-	220	0.340	1KHz/0.1v	1.100
GCPK1010N-271K01	-	270	0.400	1KHz/0.1v	1.000
GCPK1010N-331K01	-	330	0.520	1KHz/0.1v	0.930
GCPK1010N-391K01	-	390	0.650	1KHz/0.1v	0.860
GCPK1010N-471K01	-	470	0.710	1KHz/0.1v	0.780
GCPK1010N-561K01	-	560	1.000	1KHz/0.1v	0.710
GCPK1010N-681K01	-	680	1.100	1KHz/0.1v	0.650
GCPK1010N-821K01	-	820	1.300	1KHz/0.1v	0.590
GCPK1010N-102K01	-	1000	1.800	1KHz/0.1v	0.530